

# ACTUATION ACCESSORIES SOLENOID VALVES



## 8551 SERIES

### Features

- Pilot Operated
- Compact Spool Valve (Convertible from 3/2 to 5/2)
- NAMUR Pad Mount Construction
- Standard Manual Operator
- DIN, Watertight, and Explosionproof Solenoids Available
- Single and Dual Solenoid Constructions
- Mountable in Any Position
- Optional Flow Controls Available

### Specifications

Pipe Size (ins.)*	Orifice Size (ins.)*	Cv Flow Factor	Pilot Pressure (PSI)		Fluid Temperature °F			Catalog Number	Constr. Ref. No.
			Min	Max	Min	Max AC	Max DC		
1/4	1/4	0.7	30	150	-13	140	140	SC8551A001MS	1
1/4	1/4	0.7	30	150	-13	104	77	WT8551A001MS	2
1/4	1/4	0.7	30	150	-13	104	77	EF8551A001MS	2

\* 1/8 inch NPT exhaust ports

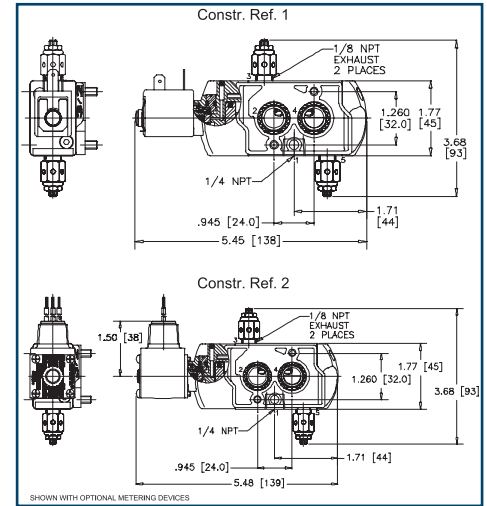

### Electrical

Standard Coil and Class of Insulation	Enclosure Type	Watt Rating and Power Consumption			
		DC Watts	Watts	VA Holding	VA Inrush
F	SC	3	2.5	3.5	6
F	WT	6.9	6.3	7	10.1
F	EF	6.9	6.3	7	10.1

Enclosures	
SC	IP65 type DIN (open frame)
WT	Types 1, 2, 3, 3S, 4, and 4X
EF	Types 3, 3S, 4, 4X, 6, 6P, 7, 9 CLASS 1, DIV.1 (Groups A-D) and CLASS 1, DIV.2 Type 9 (Groups E-G)

### Construction

Valve Parts In Contact with Fluid	
Body	Black Anodized Aluminum
Spring	Phosphate Treated Black Steel
Shading Coil	Copper
Seals	NBR and PUR
Core and Core Tube	Stainless Steel / Brass
End Covers and Plate	6/6 Glass Filled PA/FV
Spool	Aluminum
Internal Parts	Zamak, Steel, CA

### Temperature

Enclosure Type	Voltage Type	Temperature Range
SC	AC/DC	-13°F to +140°F (-25°C to 59°C)
WT / EF	AC	-13°F to +104°F (-25°C to 40°C)
WT / EF	DC	-13°F to +77°F (-25°C to 25°C)

## 8342 SERIES

### Features

- Direct Acting Operation
- High Flow Construction
- Slide Style Valve
- No Minimum Operating Pressure Differential Required to Shift Valve
- Mountable in Any Position
- Optional Flow Controls Available

### Temperature

Enclosure Type	Temperature Range
Class F	32°F to 125°F (0°C to 52°C)
Class H (optional)	32°F to 140°F (0°C to 60°C)

### Construction

Valve Parts In Contact with Fluid		
Body	Brass	304SS
Seals and Discs	NBR and FKM305 Stainless Steel	
Core Tube	305 Stainless Steel	
Core and Plugnut	430F Stainless Steel	
Springs	302 Stainless Steel / 17-7 PH Stainless Steel	
Shading Coil	Copper	
Sleeve	PA	
Seats	Graphite-filled PTFE	

### Electrical

Standard Coil and Class of Insulation	Watt Rating and Power Consumption		
	AC		
	Watts	VA Holding	VA Inrush
F	16.1	3.5	6
F	20.1	7	10.1

Enclosures	
Standard	Types 1, 2, 3, 3S, 4, and 4X
Explosionproof	Types 3, 3S, 4, 4X, 6, 6P, 7, 9

### Constr. Ref. 3

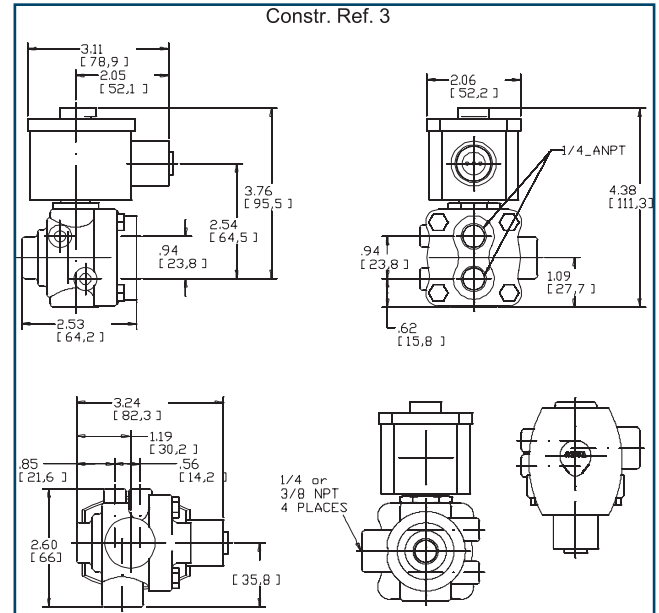

### Specifications

Pipe Size (ins.)*	Orifice Size (ins.)*	Cv Flow Factor	Pilot Pressure (PSI)			Max Fluid Temperature °F	Catalog Number		Constr. Ref. No.
			Maximum AC				Brass Body	304SS Body	
			Air-Inert Gas	Water	Lt. Oil @ 300 SSU				
1/4	3/16	0.7	125	100	100	160	8342G1	8342G701	3
3/8	3/16	0.7	125	100	100	160	8342G3	8342G703	3

\* Prefix model numbers with EF for explosionproof

